

4

3

2

1

D

D

C

C

B

B

A

A

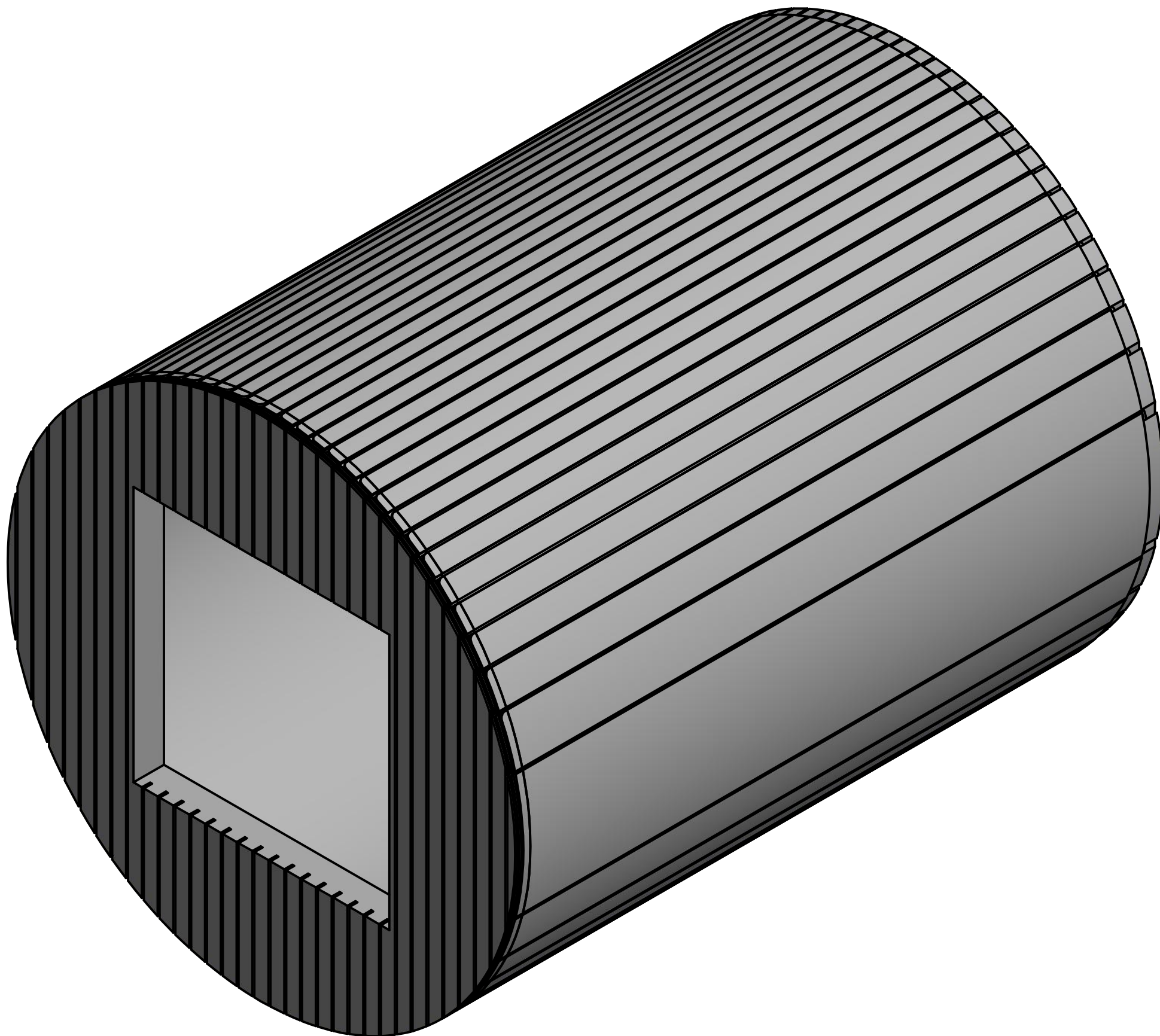
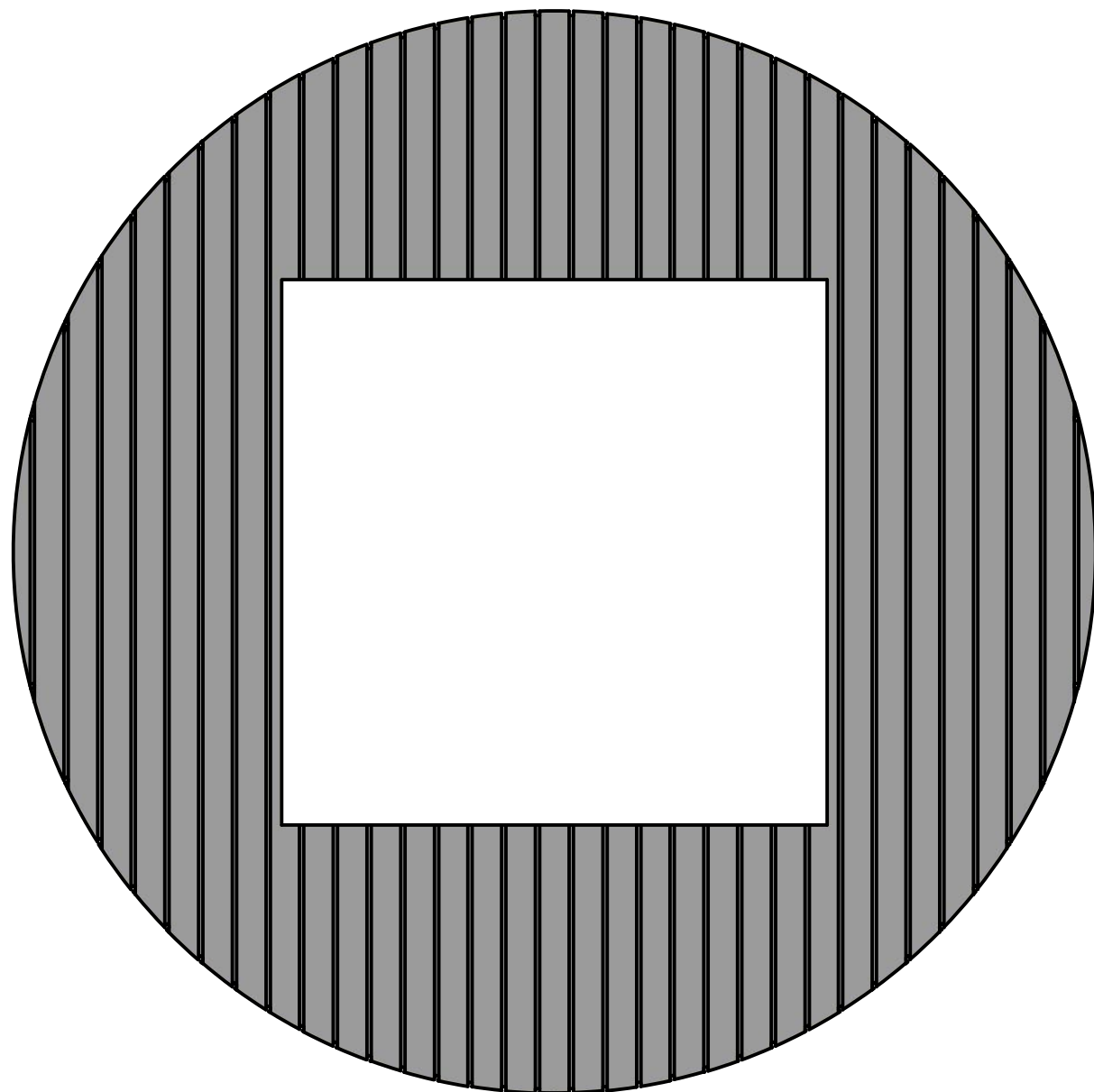

Special Instructions:

- 1. Cylinder constructed from Schedule 80 12" PVC Pipe.
- 2. End pieces constructed from 3/4 inch Acrylic sheet.
- 3. Use Glue suitable for bonding acrylic to PVC.
- 4. Ends of grooves on front end cap can be filed to facilitate routing of aluminum wire. (See designer for details).
- 5. All dimensions are in inches.

DRAWN Chrtopher Hayes	11/3/2013	University of Tennessee, Physics		
CHECKED Chris Crawford		TITLE		
QA		Inner Cylinder		
MFG Alvin Peak		SIZE C	DWG NO RFSF-01	REV
APPROVED Geoff Greene		SCALE	SHEET 1	OF 7